



BASIC TOOLS



All parts of the Basic Rescue Tools Unit are produced with heavy duty materials and with the utmost reliability in mind. The handles are made of tempered steel and are epoxy lacquered and the inner surfaces are treated with plastic oil.

The handles are equipped with a heavy duty rubber for great grip. Parts like the claw and the ax-blade are made of tempered tool-steel, and the saws and knife are made of bimetallic, non-chattering high-speed steel.

The holster is manufactured from heat resistant polyamide reinforced with glass fibre and contains ventilation holes and buttons made of brass. Further, every tool is assembled by hand and is inspected before packing. Whether in holster or plastic case, the SOS Rescue Unit is made for long-term storage.

In short the SOS Rescue unit is the worlds most versatile and portable set of rescue tools useful for everybody.



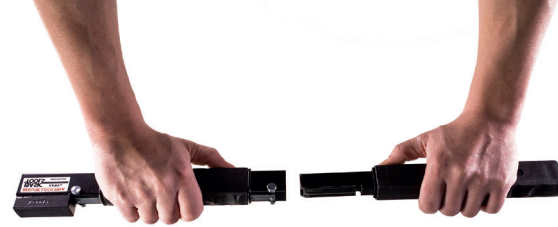

1



2





1

2





1

2





1



2



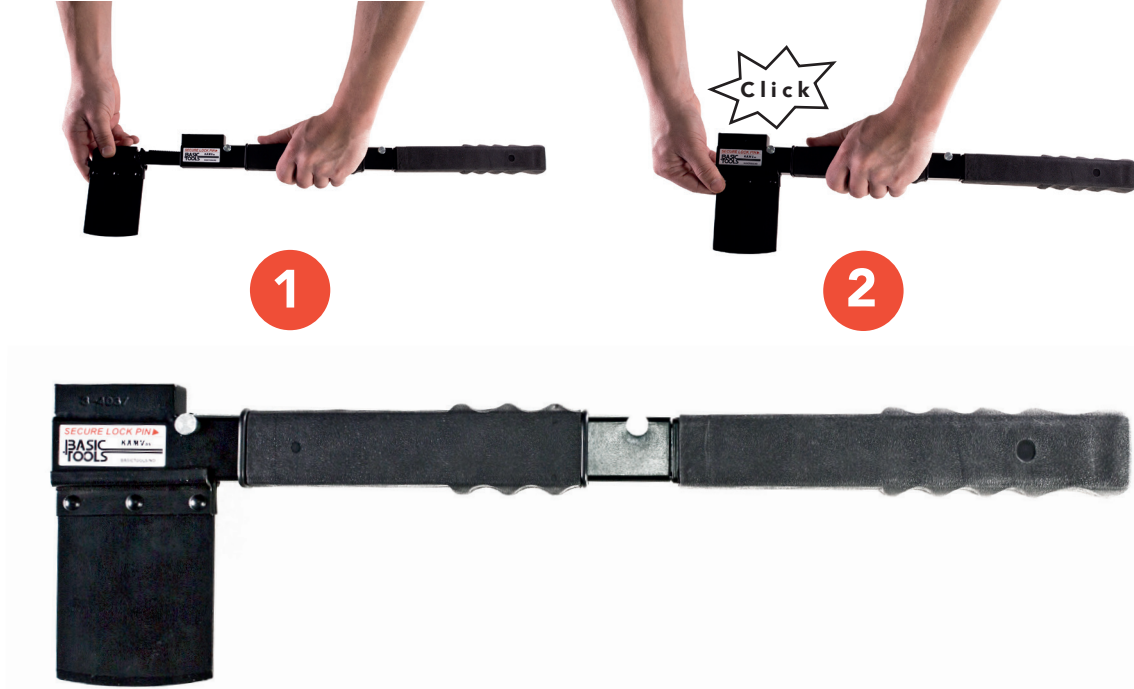



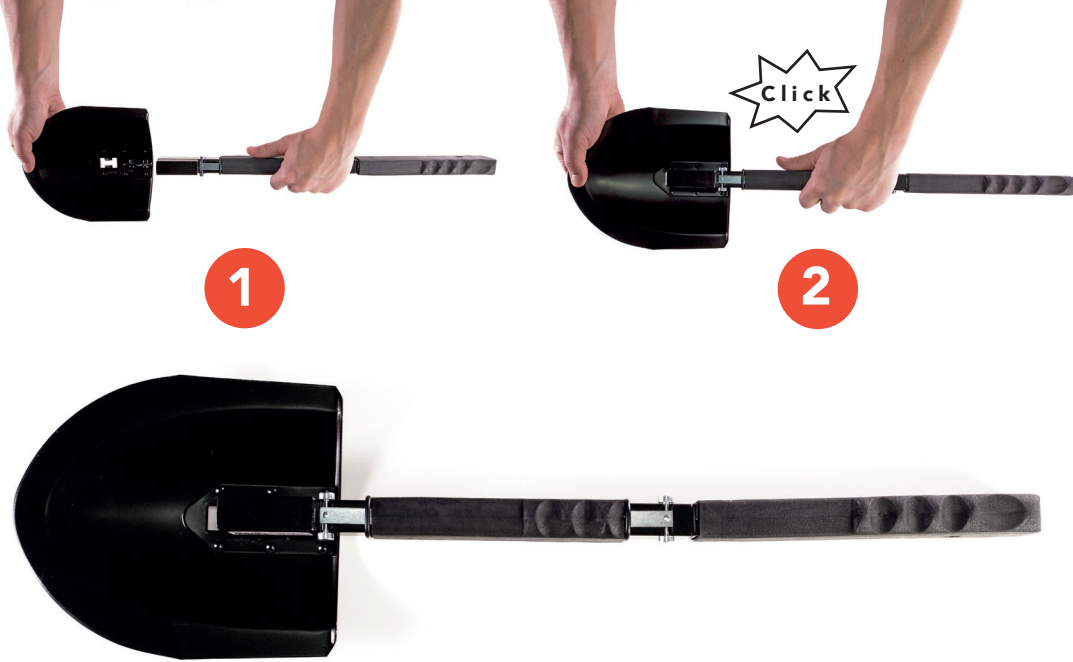

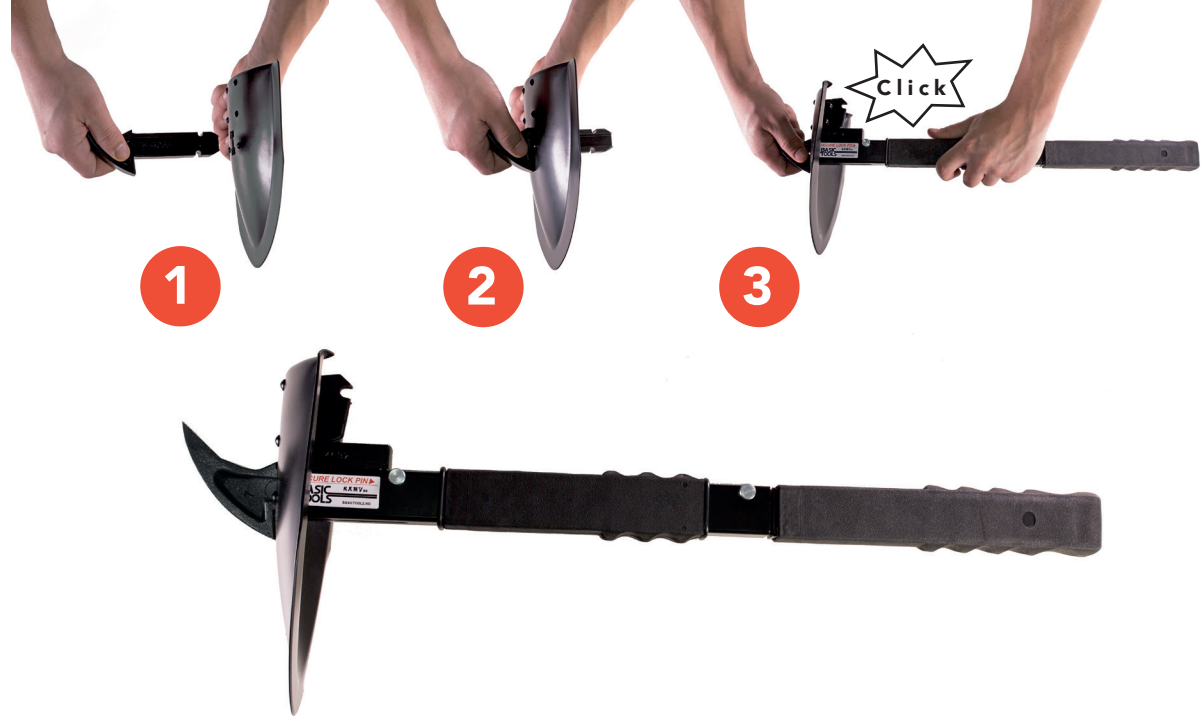

DISCONNECT



ADDITIONAL PARTS

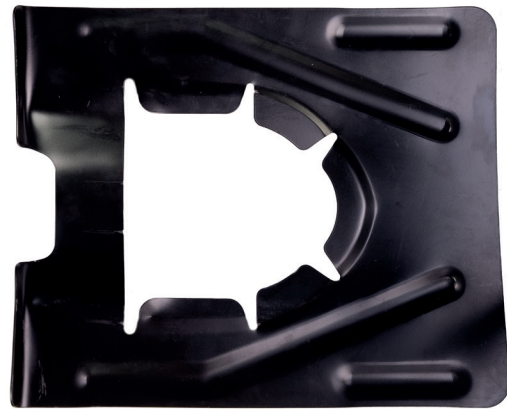



1



2

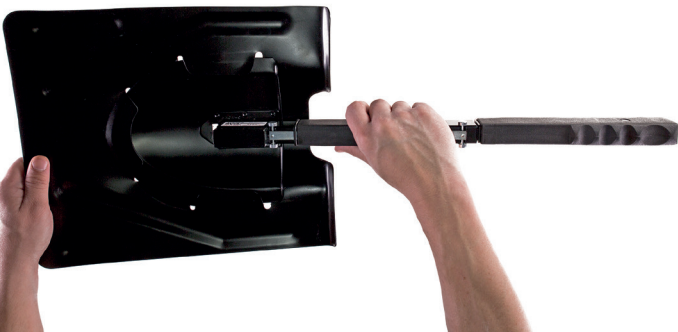



1

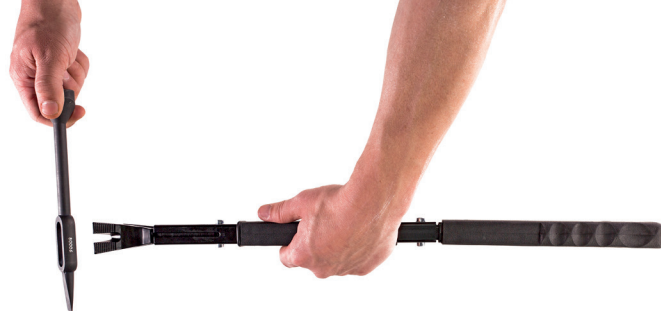

2



LOADING THE HOLSTERS





1



2



3



4





**BASIC
TOOLS**

www.basictools.no

If you have any questions or want to learn more,
please contact us at:

E-mail: mail@basictools.no • Phone: +47 62 96 42 40